



## PRODUCT SPECIFICATIONS

MODEL PXL-2 H.D.  
NON-PENETRATING OR PENETRATING  
 FLAT ROOF, ANTENNA SUPPORTING SYSTEM

### TYPICAL USAGE

1. Handles up to a 12.5' (3.8M) antenna  
 Larger antennas may be used on the PXL-2 H.D.  
 However, each installation must be examined  
 to determine if the mount can withstand the  
 wind loads it may be subjected to at the site.
2. K.U. & C band- transmit and receive
3. Pad areas: 25.00 and 33.33 sq.ft.
4. Footprints
  - a. 4' x 6' = 17.7' x 17.7' = 313.29sq.ft.
  - b. 5'4" x 6' = 20.3' x 20.3' = 412.1sq.ft.

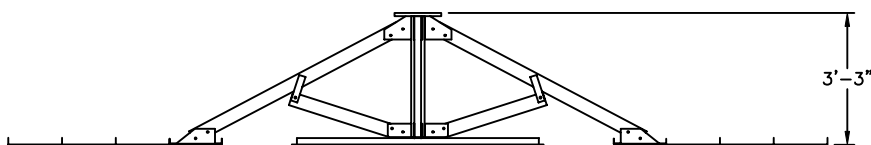
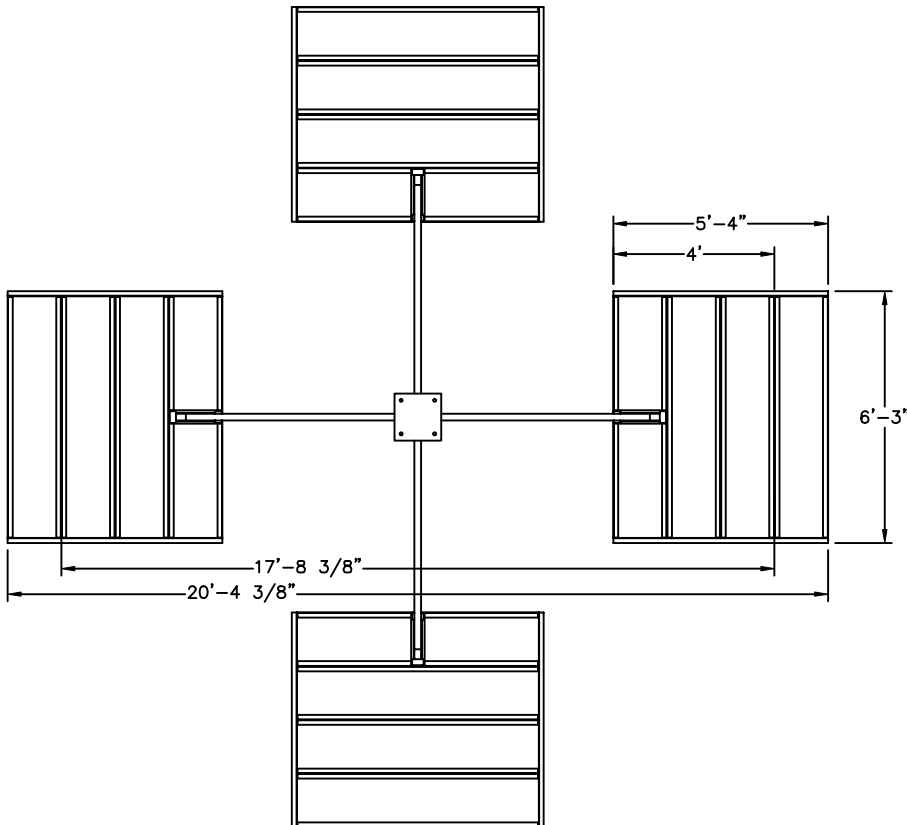

Finish - Hot dip galvanized  
 Pipe Height - as required  
 Pipe Diameter - as required

This mount if needed can be equipped with a leveling device.

Ballast required will be recommended based on antenna diameter, type and survival requirements

It is the customer's responsibility to see that all applicable codes are satisfied. It is suggested that a structural engineer review the application of this product.

An engineering report is available to assist with determining the proper amount of ballast.

A pad can be supplied to isolate the mount from the roof surface.

Under extreme wind conditions the mount should be tethered with cable .